

REPUBLIC OF BOTSWANA



# AGREEMENT OF GRANT OF LEASE FOR BUSINESS PLOTS

made and entered into by and between

THE ..... **TAWANA** ..... LAND BOARD  
(hereinafter referred to as the "Lessor") represented by ..... **OABILWE CHOMBO** ..... he being duly  
authorised thereto by a resolution of the Land Board dated **13.03.10** ..... and annexed hereto and marked "A" of the one  
part.

and

.....  
(hereinafter referred to as the "Lessee")

(hereinafter referred to as the "Lessee") represented by ..... **SELF** ..... he/she being duly  
authorised by a resolution of the Board of Directors dated **N/A** ..... annexed hereto as "A1" of the other part.

WHERE IT IS agreed as follows: —

## 1. LEASED AREA

The lessor hereby lets to the lessee who hires from the lessor the land, being the land appearing on Plan/Diagram  
D.S.M. No.....annexed hereto marked "B" and initialled by the parties for identification (hereinafter referred to as  
"the leased land") being:—

**SEE ANNEXURE "A"**

That is to say:—

**CERTAIN** piece of land  
**SITUATE** in the..... **BATAWANA** ..... Tribal Area:  
in the..... **SAFARI LODGE NXAKUKARA** ..... Village/Ward  
**MEASURING** ..... **17.2123 HACTERS** .....

## 2. PURPOSE

The leased land shall be used for ..... **MAUN/NXAKUKARA SAFARI LODGE** ..... purpose only and for no other purpose  
whatsoever save with written permission of the lessor.

*Handwritten signatures*

*Handwritten signatures*

J.M  
O.M  
L.S

"A"

RESOLUTION PASSED BY THE **TAWANA** LAND BOARD  
AT **MAUN**

ON THE **12**  
DAY OF **MARCH**, 20 **10**

RESOLVED (1) That the **TAWANA** Land Board  
enter into an Agreement of Grant of Lease with

*[Signature]*

in respect of a piece of land situated at **MAUN XAKUKARA**  
**17.2123 HACTERS**

*[Signature]*

being **50 YEARS**  
approximately in extent for an initial period of

RESOLVED (2) That **OABILWE CHOMBO** in his capacity as  
Chairman of the Land Board be and is hereby authorised to sign the Lease  
on behalf of the Land Board.

CERTIFIED A TRUE COPY

*[Signature]*  
Chairman

# CERTIFICATE ISSUED IN TERMS OF REGULATION 21 (4)

I, **OABILWE CHOMBO** .....  
in my capacity as Chairman/~~SECRETARY~~ of the .....  .....  
Land Board certify as follows: **TAWANA** .....

\*(1) That no customary rights exist with respect to the piece of land described in the accompanying Lease Agreement.

~~\*(2) That customary rights as hereunder described exist with respect to the piece of land described in the accompanying Lease Agreement but the owner has been informed of the proposed agreement and has consented to it.~~

*DESCRIPTION of existing rights*

.....  
.....  
.....  
.....  
.....  
.....

\*Delete whichever is not applicable.

Date *12-10-2010* .....

Signed  .....

TAWANA LAND BOARD

TRIBAL LEASE SKETCH FOR :

~~VEGETABLE GARDEN AND BOREHOLE Plot~~  
 SAFARI LODGE  
 NXAKUKARA  
 BOX 350056 MAUN  
 Compiled by R.L. MMU  
 Date: 26-02-09

No. File TLB/B/10/1731  
 TAWANA LAND BOARD  
 REVENUE MAUN MAIN  
 26 FEB 2010  
**B**  
 P.O. BOX 134 MAUN  
 TEL: 6860292 FAX: 6860303  
 REPUBLIC OF BOTSWANA

LOCALITY SKETCH

Scale N/A

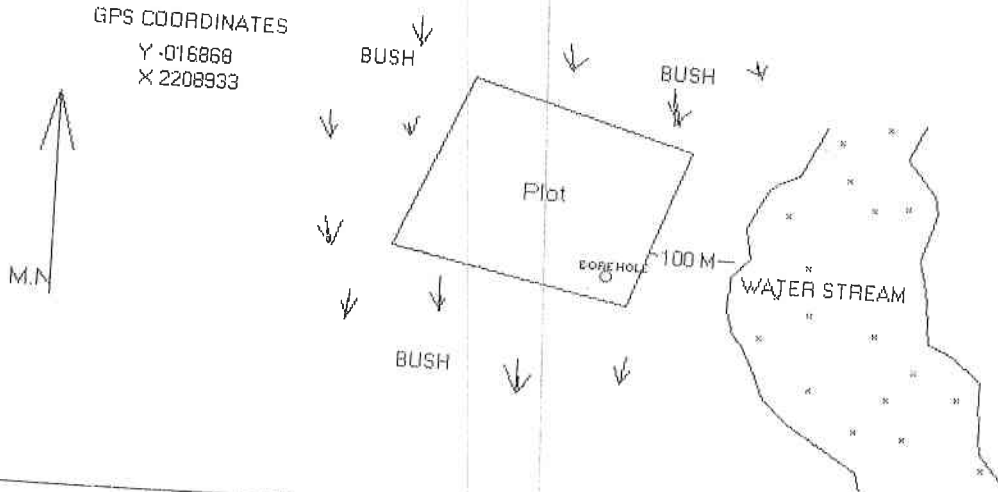

BOUNDARY SKETCH

Scale 1: 11000

	Side(m)	Bearing
AB	457	107
BC	347	199
CD	480	282
DA	393	22

The Area is about 17.2123ha

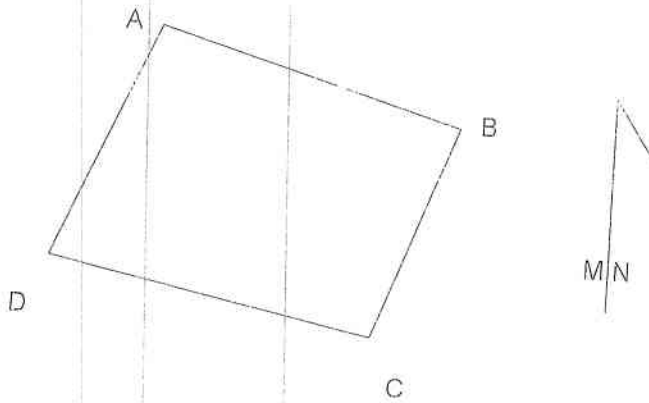

This Sketch is to be submitted to the Land Board  
 in support of an Application for a Tribal Lease.  
 It does not imply any rights to the land.

*Handwritten initials/signature*

Land Board Stamp

*Handwritten signatures:*  
 J.M  
 O.M  
 L.S

# TAWANA LAND BOARD



Fax No. 6860603

Tel No. 6860292/477

Correspondence to be addressed  
To The Board Secretary  
P.O. Box 134, Maun

REF: TLB/B/10/1731

Date: 22 March 2010

Dear Sir/Madam

**APPLICATION FOR A CHANGE OF LAND USE AT NXAKUKARA FROM  
GARDEN AND BOREHOLE TO A SAFARI LODGE**

Kindly refer to the above subject matter.

This serves to inform you that your application for a change of land use at Nxakukara from garden and borehole to a Safari Lodge was approved by the Board at its meeting held on the 12<sup>th</sup> March 2010

The lease is being processed and you will be notified when ready for collection.

Thank you.

Yours faithfully

  
F Ntsuke

**FOR/BOARD SECRETARY**

**CC: Revenue office**

# NGAMILAND INTEGRATED LANDUSE PLAN (2008)

Map Title

## Recommended Ngamiland Land Use Plan

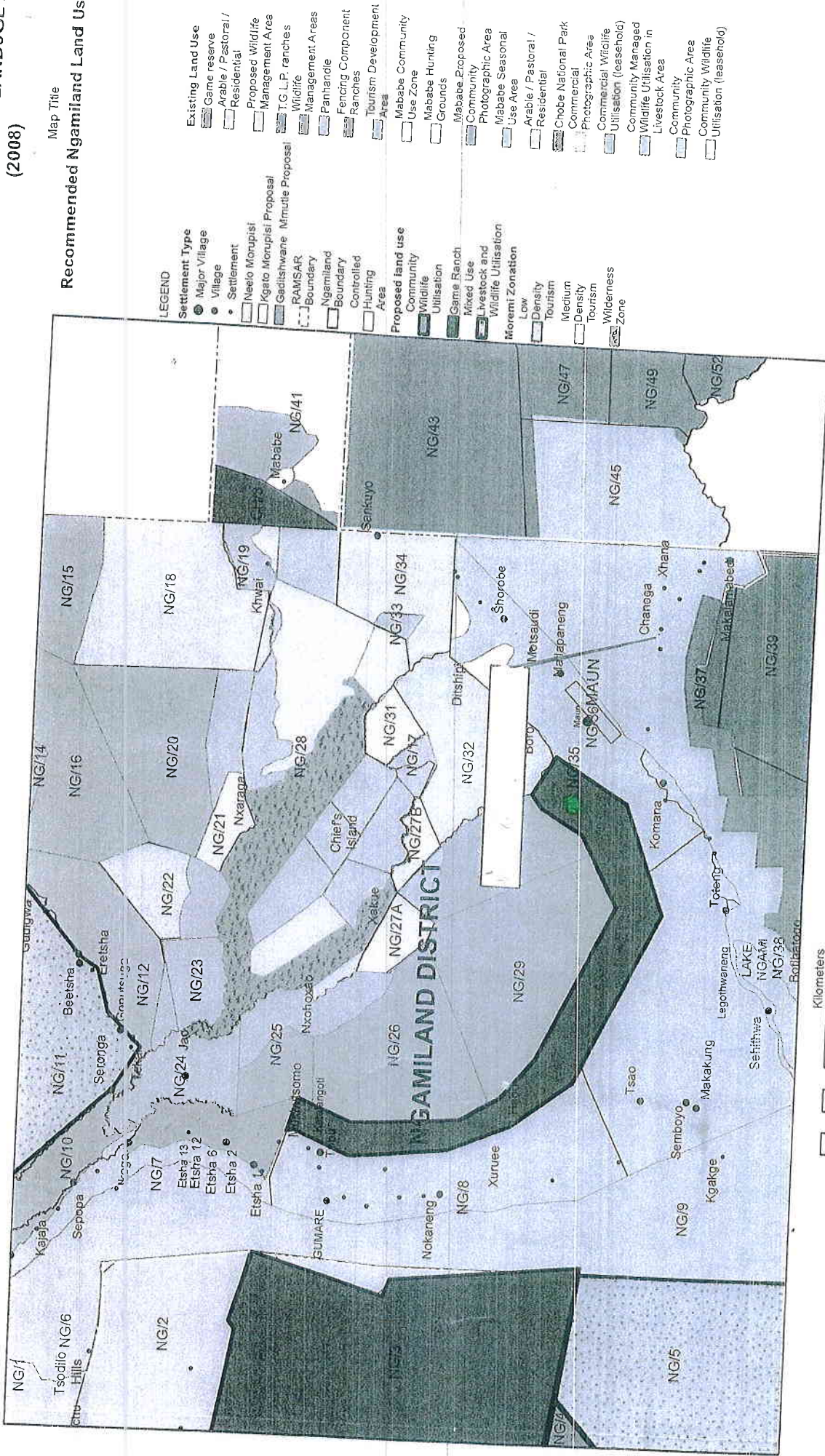

- LEGEND**
- Settlement Type**
    - Major Village
    - Village
    - Settlement
    - Neelo Morupisi
    - Ngato Morupisi Proposal
    - Gaditshwane Mmuthu Proposal
    - RAMSAR
    - Boundary
    - Ngamiland Boundary
    - Controlled Hunting Area
  - Existing Land Use**
    - Game reserve
    - Arable / Pastoral / Residential
    - Proposed Wildlife Management Area
    - T.G L.P. ranches
    - Wildlife Management Areas
    - Panhandle
    - Fencing Component
    - Ranches
    - Tourism Development Area
  - Proposed land use**
    - Mababe Community Use Zone
    - Mababe Hunting Grounds
    - Mababe Proposed Community
    - Photographic Area
    - Mababe Seasonal Use Area
    - Arable / Pastoral / Residential
    - Chobe National Park
    - Commercial Photographic Area
    - Commercial Wildlife Utilisation (leasehold)
    - Community Managed Wildlife Utilisation in Livestock Area
    - Community Photographic Area
    - Community Wildlife Utilisation (leasehold)
  - Moremi Zonation**
    - Low Density Tourism
    - Medium Density Tourism
    - Wilderness Zone
  - Other**
    - Game Ranch
    - Mixed Use
    - Livestock and Wildlife Utilisation

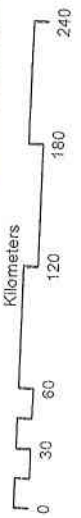

Map Compilation: Spatial Dynamics

**Department of Lands**

**CLIENT:**



DATA SOURCES:

Base data revised and updated from the DSM topographic map sheet series using Arcinfo 8 and ArcView 8. National Settlement Policy, BRIMP (2002).

COMPILED BY: ONALETHATA SEHULARO  
DATE: 08/02/2018

PROJECTION: BNGRS\_GCS\_LATLONG  
DATUM: D\_GRS\_1980

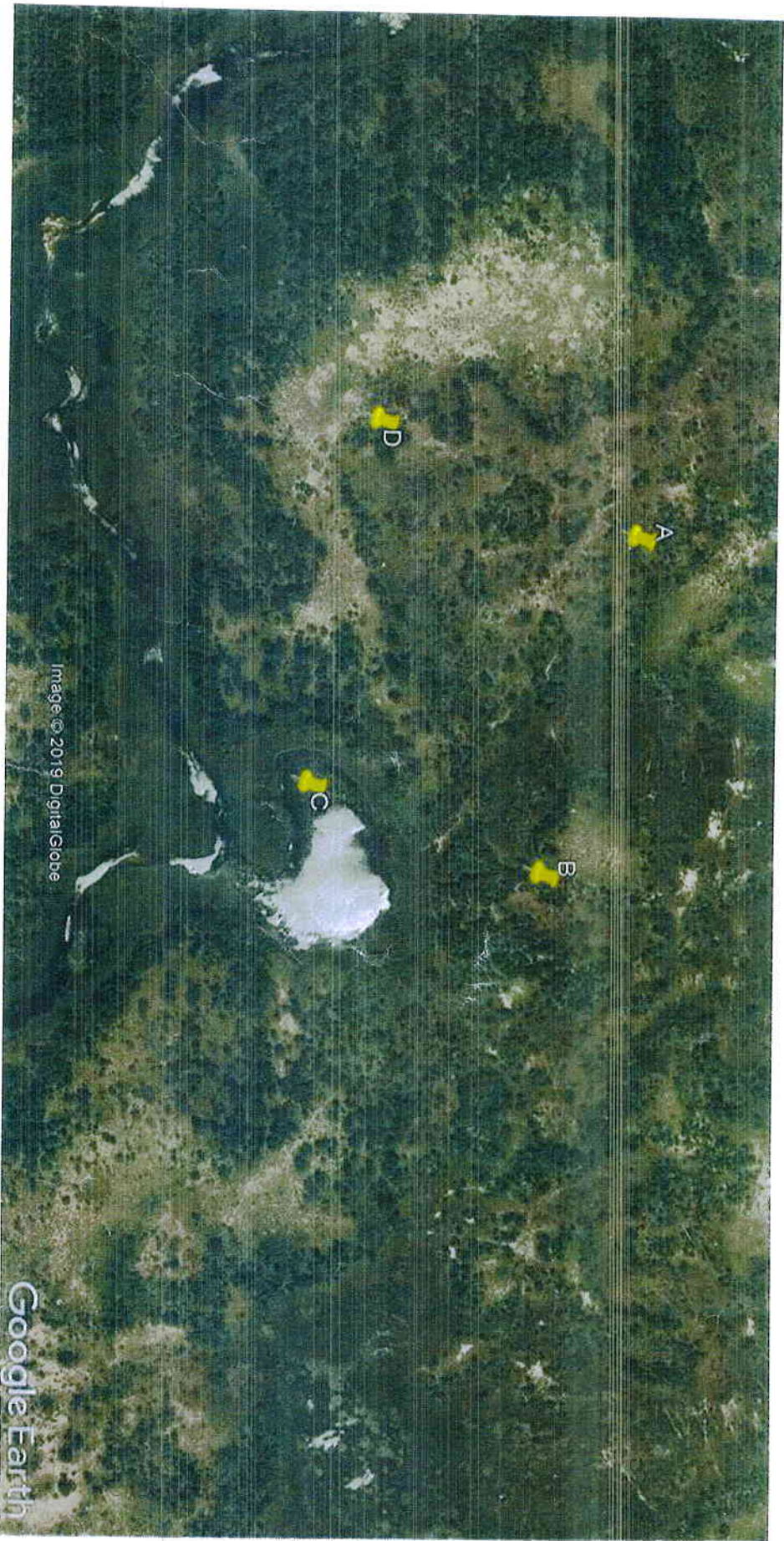

A 19° 58'15.81"S, 23°9'44.31"E

B 19° 58'20.13"S, 23°9'59.36"E

C 19° 58'30.82"S, 23°9'55.47"E

D 19° 58'27.69"S, 23°9'39.27"E

18,97166,5  
E 23.16 231